

A  
B  
C  
D  
E  
F  
REVDATE  
FNAME  
USER

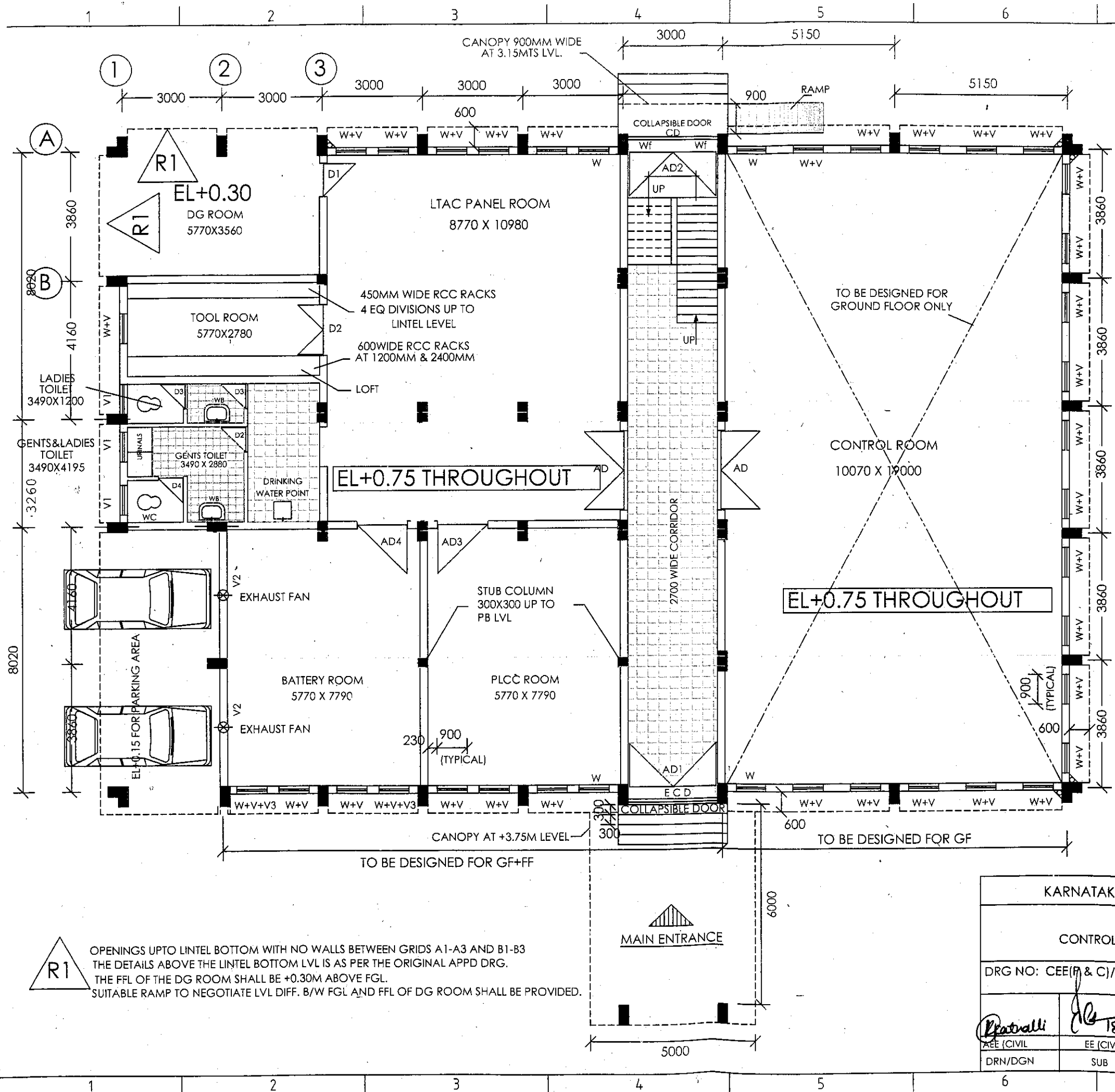

| SCHEDULE OF OPENINGS         |                                  |     |           |     |            |          |
|------------------------------|----------------------------------|-----|-----------|-----|------------|----------|
| SL                           | TYPE                             |     | SIZE      | QTY | SIL LVL    | LNTL LVL |
| <b>STEEL DOORS</b>           |                                  |     |           |     |            |          |
| 1                            | ROLLING SHUTTER                  | RS  | 2700X2400 | 01  | 750        | 3150     |
| 2                            | COLLAPSIBLE DOOR                 | CD  | 2700X2400 | 01  | 750        | 3150     |
| 3                            | COLLAPSIBLE DOOR                 | ECD | 2700X3000 | 01  | 750        | 3750     |
| <b>ALUMINIUM DOORS</b>       |                                  |     |           |     |            |          |
| 4                            | DOUBLE SHUTTER DOOR              | AD  | 2400X3000 | 02  | 750        | 3750     |
| 5                            | DOUBLE SHUTTER DOOR              | AD1 | 2700X3000 | 01  | 750        | 3750     |
| 6                            | DOUBLE SHUTTER DOOR              | AD2 | 2700X2400 | 01  | 750        | 3150     |
| 7                            | SINGLE SHUTTER DOOR              | AD3 | 1500X2400 | 01  | 750        | 3150     |
| 8                            | SINGLE SHUTTER DOOR              | AD4 | 1500X2400 | 01  | 750        | 3150     |
| <b>WOODEN DOORS</b>          |                                  |     |           |     |            |          |
| 9                            | SINGLE SHUTTER DOOR              | D1  | 1000X2400 | 02  | 750        | 3150     |
| 10                           | DOUBLE SHUTTER DOOR              | D2  | 1500X2400 | 01  | 750        | 3150     |
| 11                           | SINGLE SHUTTER DOOR              | D3  | 750X2100  | 03  | 750        | 2850     |
| <b>ALUMINIUM WINDOWS</b>     |                                  |     |           |     |            |          |
| 12                           | WINDOW FIXED (FOR STAIRS)        | Wf  | 600X2400  | 02  | 4300       | 6700     |
| 13                           | WINDOWS OPENABLE TYPE            | W   | 900X1500  | 39  | 1650       | 3150     |
| <b>ALUMINIUM VENTILATORS</b> |                                  |     |           |     |            |          |
| 14                           | Z' TYPE VENTILATOR               | V   | 900X450   | 35  | BELOW BEAM |          |
| 15                           | LOUVERS TYPE                     | V1  | 900X450   | 03  | 2700       | 3150     |
| 16                           | BELOW CILL LVL (IN BATTERY ROOM) | V2  | 600X300   | 02  | 1250       | 1550     |
| 17                           | VENTILATOR FOR EXHAUST FAN       | V3  | 600X600   | 03  | BELOW BEAM |          |

**R1**  
 OPENINGS UP TO LINTEL BOTTOM WITH NO WALLS BETWEEN GRIDS A1-A3 AND B1-B3  
 THE DETAILS ABOVE THE LINTEL BOTTOM LVL IS AS PER THE ORIGINAL APPD DRG.  
 THE FFL OF THE DG ROOM SHALL BE +0.30M ABOVE FGL.  
 SUITABLE RAMP TO NEGOTIATE LVL DIFF. B/W FGL AND FFL OF DG ROOM SHALL BE PROVIDED.

**KARNATAKA POWER TRANSMISSION CORPORATION LTD**  
 220KV SUB STATION  
 CONTROL ROOM: GROUND FLOOR PLAN.

SHEET 1 OF 1

DRG NO: CEE(F & C)/SE(C)/06-07/220/001-R1

|                 |                 |                 |  |
|-----------------|-----------------|-----------------|--|
| <i>Prasanna</i> | <i>18/10/11</i> | <i>18.10.11</i> | <i>My...</i>                               |
| DRN/DGN         | EE (CIVIL)      | SE (CIVIL)      | CHIEF ENGINEER ELE<br>PLNG & CO ORDINATION |
| SUB             | REC             | APPROVED        | PLANNING AND CO ORDINATION                 |